

The  
ALEXANDER HOTEL  
*Collection*



*Meetings & Events*

The  
ALEXANDER HOTEL  
Collection

*Creative Spaces*

From the historic Tithe Barn at Great Fosters, to the sleek Pavilion of Rowhill Grange, our collection of historic country house hotels feature all manner of creative, inspiring and luxurious spaces.

Established for over twenty years, we are proud to have created a legacy of superb events delivered by our team of exceptional event professionals.

*For work & play*

As well the finest business, conference and meeting settings, each hotel offers a range of options for productive and fun team building. From croquet and clay pigeon shooting to bike rides, woodland walks, tennis competitions and wine-tasting, there are all sorts of ways to take advantage of each idyllic retreat. Got a team-building idea of your own? Let us know and we'll set our minds to it.





ALEXANDER HOUSE

*Hotel & Utopia Spa*



**ALEXANDER HOUSE**  
*Hotel & Utopia Spa*

A transformed Jacobean mansion, Alexander House was once the residence of Percy & Mary Shelley. Today, our five-red star property is comprised of 58 rooms & suites, 7 private hire spaces, a Champagne bar, several terraces and courtyards and a Utopia spa. Our largest suite, named after the Shelleys, holds 90 guests and can be combined with the Wakehurst for larger events of up to 130. More intimate occasions can enjoy such beautiful drawing rooms as the Asquith & Churchill.

Turner's Hill, East Grinstead, RH10 4QD [www.alexanderhouse.co.uk](http://www.alexanderhouse.co.uk)



**ALEXANDER HOUSE**  
*Hotel & Utopia Spa*

Set in 120 acres of gardens,  
Alexander House is just 20 minutes  
from Gatwick Airport and  
30 minutes from London Victoria.

Turner's Hill, East Grinstead, RH10 4QD  
[www.alexanderhouse.co.uk](http://www.alexanderhouse.co.uk)



*Clockwise from left: Shelley Suite, spa garden at Utopia Spa, The Asquith Suite and Champagne Bar*

### ROOM CONFIGURATION AND CAPACITY

Configuration	Shelley	Wakehurst	Asquith	Churchill	Chalfont	The Boardroom	AG's
Boardroom	45	26	8	14	10	10	20
Private Dining	90	30	10	16	14	10	40
Cabaret	56	26	-	-	-	-	30
U-Shape	60	24	-	12	-	-	20
Theatre	100	30	-	20	-	-	40



## ROOM OPTIONS IN MORE DETAIL

### ASQUITH SUITE

Perfectly formed traditional suite with views of the south gardens.



#### BOARDROOM

Up to 8 delegates

#### U-SHAPE

N/A

#### CABARET

N/A

#### THEATRE STYLE

N/A

#### PRIVATE DINING

Up to 10 guests

### THE BOARDROOM

Fully air-conditioned modern boardroom offering a comfortable environment for high power executive meetings.

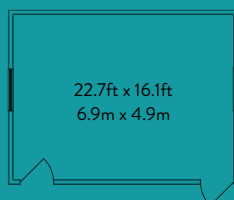

#### BOARDROOM

Up to 10 delegates

#### U-SHAPE

N/A

#### CABARET

N/A

#### THEATRE STYLE

N/A

#### PRIVATE DINING

N/A

### CHALFONT SUITE

Intimate suite that retains elegant 17th Century oak panelling.

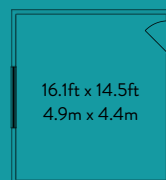

#### BOARDROOM

Up to 10 delegates

#### U-SHAPE

N/A

#### CABARET

N/A

#### THEATRE STYLE

N/A

#### PRIVATE DINING

Up to 10 guests

### CHURCHILL SUITE

Luxuriously appointed south facing room that lends itself to the modern business meeting but also suits a special occasion or business supper.



#### BOARDROOM

Up to 14 delegates

#### U-SHAPE

Up to 12 delegates

#### CABARET

N/A

#### THEATRE STYLE

Up to 20 delegates

#### PRIVATE DINING

Up to 16 guests

### SHELLEY SUITE

Purpose built suite equipped with modern technology, stage setting or dance floor, air-conditioning and direct access to a private garden.

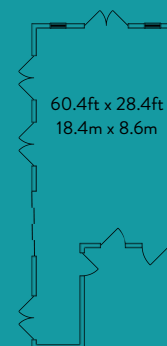

#### BOARDROOM

Up to 45 delegates

#### U-SHAPE

Up to 60 delegates

#### CABARET

Up to 56 delegates

#### THEATRE STYLE

Up to 100 delegates

#### PRIVATE DINING

Up to 90 guests

### WAKEHURST SUITE

Syndicate area or private meeting room with direct access to a discreet terrace.



#### BOARDROOM

Up to 26 delegates

#### U-SHAPE

Up to 24 delegates

#### CABARET

Up to 26 delegates

#### THEATRE STYLE

Up to 30 delegates

#### PRIVATE DINING

Up to 30 guests

### AG's

Elegant decor and tastefully appointed furnishings suited to a variety of room layouts.

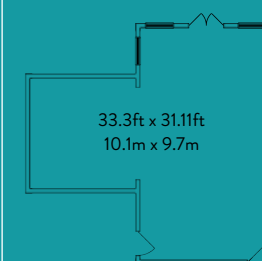

#### BOARDROOM

Up to 20 delegates

#### U-SHAPE

Up to 20 delegates

#### CABARET

Up to 30 delegates

#### THEATRE STYLE

Up to 40 delegates

#### PRIVATE DINING

Up to 40 guests



**GREAT FOSTERS**  
*Historic Hotel & Gardens*



# GREAT FOSTERS

*Historic Hotel & Gardens*

One of the most important historic buildings in the UK, Great Fosters is steeped in Tudor history. This magnificent boutique hotel has acres of glorious gardens (ideal for team building), 56 rooms & suites, 7 private hire spaces, a Cocktail Bar, Painted Hall Bar, several terraces with a wood fired pizza oven and much more - including a Saxon moat and grassed amphitheatre! The hotel accommodates up to 120 guests theatre style in the ancient Tithe Barn. Smaller meetings are perfectly suited to the self contained Coach House which includes three ground floor meeting spaces, spacious lounge and walled garden.

Stroude Road, Egham, near Windsor, TW20 9UR | [www.greatfosters.co.uk](http://www.greatfosters.co.uk)



# GREAT FOSTERS

*Historic Hotel & Gardens*

Steeped in Tudor history and set in acres of exquisite gardens, Great Fosters is a stone's throw from London Heathrow and 40 minutes from London Waterloo.

Stroude Road, Egham,  
near Windsor, TW20 9UR  
[www.greatfosters.co.uk](http://www.greatfosters.co.uk)



*Clockwise from left: The Tithe Barn, the Clarence, the Mowbray and the Orangery*



## ROOM CONFIGURATION AND CAPACITY

Configuration	Tithe Barn	Orangery	Mowbray	Mandeville	Clarence	Victoria	Concord
Boardroom	40	40	20	8	22	16	10
Private Dining	180	80	24	8	-	-	-
Cabaret	42	48	15	-	-	-	-
U-Shape	40	40	20	-	22	16	10
Theatre	120	120	30	-	30	-	-

# ROOM OPTIONS IN MORE DETAIL

## THE COACH HOUSE

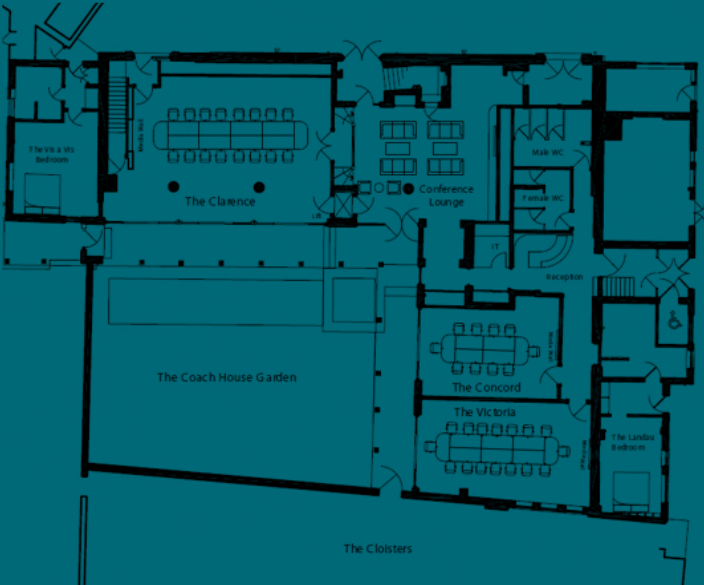

## THE MOWBRAY & MANDEVILLE



## TITHE BARN EVENT SPACE

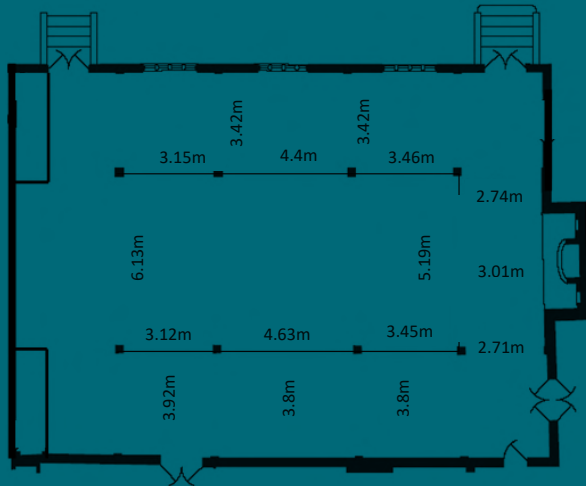

## THE ORANGERY

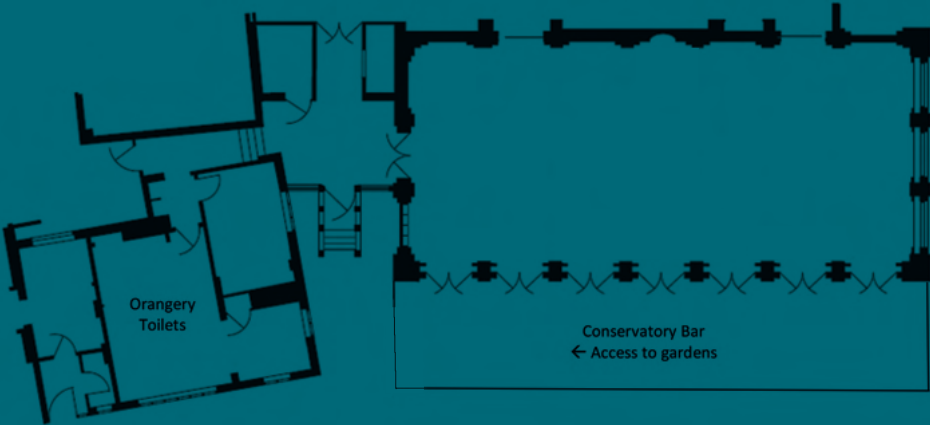



ROWHILL GRANGE

*Hotel & Utopia Spa*



## ROWHILL GRANGE

*Hotel & Utopia Spa*

Rowhill Grange is undeniably beautiful - originally built as a holiday home for Alice Alexander over 150 years ago, it still bears a New England charm and certainly evokes the sense of escape. With 38 rooms & suites, 6 meeting rooms and 15 acres of gardens it perfectly caters for smaller and larger groups alike. The Pavilion and The Clockhouse are both separate to the Main House and offer exclusive use options. Additionally, Rowhill Grange has several terraces overlooking the gardens, Elements Bar & Lounge and the rosetted restaurant, RGs.

Top Dartford Road, Dartford, Kent DA2 7QH | [www.rowhillgrange.co.uk](http://www.rowhillgrange.co.uk)



**ROWHILL GRANGE**  
*Hotel & Utopia Spa*

Rowhill Grange is just 12 miles from London City Airport, and 30 minutes from London Victoria to Swanley Station, 2 miles from the hotel.

Top Dartford Road, Dartford,  
Kent DA2 7QH  
[www.rowhillgrange.co.uk](http://www.rowhillgrange.co.uk)



*Clockwise from left: The indoor pool at Utopia Spa, a Double room, private dinner in the Drawing Room and the Pavilion meeting room*

**ROOM CONFIGURATION AND CAPACITY**

Configuration	Pavilion	Hub	Wicket	Drawing Room	Clockhouse Suite	Cottage Suite
Boardroom	24	8	18	14	34	26
Private Dining	-	-	-	16	130	32
Cabaret	30	-	-	-	40	15
U-Shape	22	10	12	15	30	26
Theatre	50	-	20	20	160	64

*\* Can be combined to create the Pavilion Conference Suite*



## ROOM OPTIONS IN MORE DETAIL

### THE PAVILION

**CONFERENCE CENTRE**  
Stylishly designed intelligent 'think space' environment with modern technology, mood lighting, reception area and private terrace.

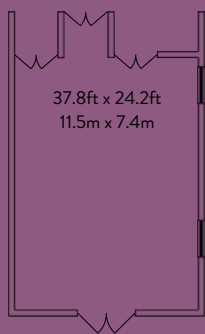

**BOARDROOM**  
up to 24 delegates

**U-SHAPE**  
up to 22 delegates with tables  
up to 26 delegates without tables

**CABARET**  
up to 30 delegates

**THEATRE STYLE**  
up to 50 delegates

**PRIVATE DINING**  
N/A

### THE HUB

Located on the upper floor of The Pavilion, The Hub is an elegant meeting space appropriate for cosy gatherings.

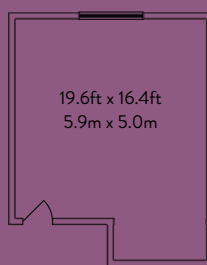

**BOARDROOM**  
up to 8 delegates

**U-SHAPE**  
up to 10 delegates with tables  
up to 12 delegates without tables

**CABARET**  
N/A

**THEATRE STYLE**  
N/A

**PRIVATE DINING**  
N/A

### THE WICKET

Adjacent to The Hub offering an intimate atmosphere and sophisticated setting.

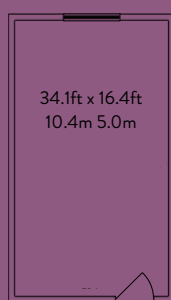

**BOARDROOM**  
up to 18 delegates

**U-SHAPE**  
up to 12 delegates with tables  
up to 14 delegates without tables

**CABARET**  
N/A

**THEATRE STYLE**  
up to 20 delegates

**PRIVATE DINING**  
N/A

### THE DRAWING ROOM

Oak-panelled boardroom that artfully blends 18th century charm with modern amenities and garden views.



**BOARDROOM**  
up to 14 delegates

**U-SHAPE**  
up to 15 delegates with tables  
up to 20 delegates without tables

**CABARET**  
N/A

**THEATRE STYLE**  
up to 20 delegates

**PRIVATE DINING**  
N/A

### CLOCKHOUSE SUITE

A gracious setting with plenty of natural character. Equipped with modern technology, stage setting or dance floor, air conditioning, private bar and courtyard.

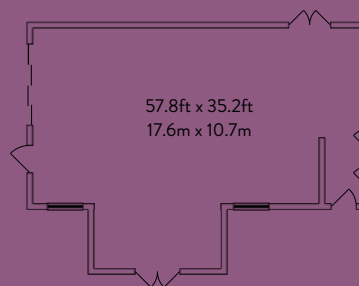

**BOARDROOM**  
up to 34 delegates

**U-SHAPE**  
up to 30 delegates with tables  
up to 36 delegates without tables

**CABARET**  
up to 40 delegates

**THEATRE STYLE**  
up to 160 delegates

**PRIVATE DINING**  
up to 130 guests

### COTTAGE SUITE

Named accordingly because of its cosy fireplace and warm atmosphere.

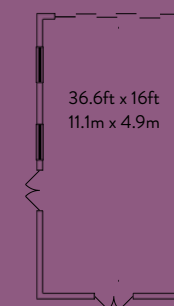

**BOARDROOM**  
up to 26 delegates

**U-SHAPE**  
up to 23 delegates with tables  
up to 26 delegates without tables

**CABARET**  
up to 15 delegates

**THEATRE STYLE**  
up to 64 delegates

**PRIVATE DINING**  
N/A



**BARNETT HILL**  
*A Surrey Hills Destination*



**BARNETT HILL**  
*A Surrey Hills Destination*

Barnett Hill is truly a treasure of a property tucked away behind a sweeping driveway high in the Surrey Hills. Its rich history began as a private residence for the Thomas Cook family, before going on to become a Red Cross Hospital during WW2. Barnett Hill today is a beautiful design hotel with 56 rooms & suites, 9 private hire spaces, a series of terraces which look over 26 acres of grounds and a beautiful rosetted restaurant, The Oak Hall and the 1905 cocktail bar. Barnett Hill can accommodate up to 100 guests and makes a perfect option for exclusive hire.

Blackheath Lane, Near Guildford, GU5 0RF | [www.barnetthillhotel.co.uk](http://www.barnetthillhotel.co.uk)



**BARNETT HILL**  
A Surrey Hills Destination

Located 26 miles from Heathrow and 37 from Gatwick, Barnett Hill is easily reachable with connections via Guildford.

Blackheath Lane,  
Near Guildford, GU5 0RF  
[www.barnetthillhotel.co.uk](http://www.barnetthillhotel.co.uk)



*Clockwise from left: The Drawing Room, Beatrice Cook Master Suite, main hallway and the Chestnut*



**ROOM CONFIGURATION AND CAPACITY**

Configuration	Garden Suite	Chestnut	Acer	Drawing Room	Wine Room	Feathers	Albury	Dunsfold	Chilworth	Bramley
Boardroom	32	18	10	24	-	-	16	10	12	14
Private Dining	80	25	12	40	8	12	-	-	-	-
Cabaret	45	16	8	30	-	-	-	-	-	-
U-Shape	30	16	8	20	-	-	16	12	10	10
Theatre	80	30	15	70	-	-	-	-	-	8

## ROOM OPTIONS IN MORE DETAIL

### GARDEN SUITE

The largest meeting room with views onto the gardens to the side of the house. The Garden is air-conditioned, has natural daylight and is a great setting for larger conferences.



- CABARET**  
up to 45 delegates
- HOLLOW SQUARE**  
up to 32 delegates
- BOARDROOM**  
up to 32 delegates
- CLASSROOM**  
up to 40 delegates
- THEATRE**  
up to 80 delegates
- U-TABLES**  
up to 30 delegates
- U-CHAIRS**  
up to 30 delegates
- DINNER**  
up to 80 delegates

### CHESTNUT

Located on the first floor, this meeting room is south facing, benefiting from natural daylight.



- CABARET**  
up to 16 delegates
- HOLLOW SQUARE**  
up to 18 delegates
- BOARDROOM**  
up to 18 delegates
- CLASSROOM**  
up to 10 delegates
- THEATRE**  
up to 30 delegates
- U-TABLES**  
up to 16 delegates
- U-CHAIRS**  
up to 18 delegates
- DINNER**  
up to 25 delegates

### ACER

A first floor meeting room with views over the grounds. Can interconnect with the Chestnut Suite.

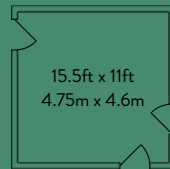

- CABARET**  
up to 8 delegates
- HOLLOW SQUARE**  
up to 10 delegates
- BOARDROOM**  
up to 10 delegates
- CLASSROOM**  
up to 4 delegates
- THEATRE**  
up to 15 delegates
- U-TABLES**  
up to 8 delegates
- U-CHAIRS**  
up to 12 delegates
- DINNER**  
up to 12 delegates

### DRAWING ROOM

An attractive walnut-panelled room with beautiful period features. It is a particularly special setting for senior-level strategy meetings, exclusive corporate entertaining and AGMs.

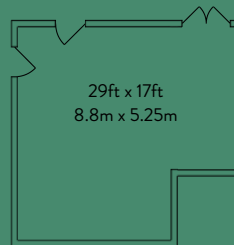

- CABARET**  
up to 30 delegates
- HOLLOW SQUARE**  
up to 24 delegates
- BOARDROOM**  
up to 24 delegates
- CLASSROOM**  
up to 30 delegates
- THEATRE**  
up to 70 delegates
- U-TABLES**  
up to 20 delegates
- U-CHAIRS**  
up to 26 delegates
- DINNER**  
up to 40 delegates

### DUNSFOLD

Located on the second floor with panoramic views of the surrounding countryside.

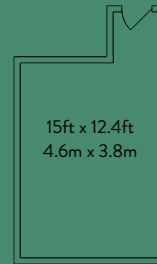

- CABARET**  
N/A
- HOLLOW SQUARE**  
N/A
- BOARDROOM**  
up to 10 delegates
- CLASSROOM**  
N/A
- THEATRE**  
N/A
- U-TABLES**  
N/A
- U-CHAIRS**  
up to 12 delegates
- DINNER**  
N/A

### CHILWORTH

A small meeting room located on the second floor with panoramic views of the countryside.



- CABARET**  
N/A
- HOLLOW SQUARE**  
N/A
- BOARDROOM**  
up to 12 delegates
- CLASSROOM**  
N/A
- THEATRE**  
N/A
- U-TABLES**  
N/A
- U-CHAIRS**  
up to 12 delegates
- DINNER**  
N/A

### BRAMLEY

A small meeting room located on the second floor with panoramic views of the countryside. Can interconnect with Bramley.

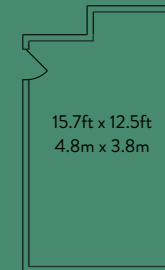

- CABARET**  
N/A
- HOLLOW SQUARE**  
N/A
- BOARDROOM**  
up to 14 delegates
- CLASSROOM**  
N/A
- THEATRE**  
up to 8 delegates
- U-TABLES**  
N/A
- U-CHAIRS**  
up to 10 delegates
- DINNER**  
N/A

### ALBURY

A small meeting room located on the second floor with panoramic views of the countryside. Can interconnect with Bramley.



- CABARET**  
N/A
- HOLLOW SQUARE**  
N/A
- BOARDROOM**  
up to 16 delegates
- CLASSROOM**  
N/A
- THEATRE**  
N/A
- U-TABLES**  
N/A
- U-CHAIRS**  
up to 16 delegates
- DINNER**  
N/A



LANGSHOTT MANOR

*Historic Elizabethan Hotel*



## LANGSHOTT MANOR

*Historic Elizabethan Hotel*

Langshott Manor dates back to 1580 making it our second Tudor-era property. Very much in the Elizabethan style, Langshott Manor is charming and characterful with warm, exposed original brickwork, wooden beams and roaring fireplaces. Now the hotel is home to 22 rooms and suites, 4 private hire spaces, our beautiful two-rosette restaurant The Mulberry as well as terraces overlooking the beautiful garden and original moat. Langshott Manor is perfect for exclusive use and you can expect an especially warm welcome and to feel right at home.

Ladbroke Road, Horley, Surrey RH6 8PB | [www.langshottmanor.co.uk](http://www.langshottmanor.co.uk)



# LANGSHOTT MANOR

*Historic Elizabethan Hotel*

The hotel is just five minutes from Gatwick and under an hour to London Victoria from the Horley connection.

Ladbroke Road, Horley,  
Surrey RH6 8PB  
[www.langshottmanor.co.uk](http://www.langshottmanor.co.uk)



*Clockwise from left: The Gallery, the morning room, a splendid suite and the lounge*



## ROOM CONFIGURATION AND CAPACITY

Configuration	Gallery	Moat Room	Mulberry
Boardroom	14	20	30
Private Dining	14	20	60
U-Shape	12	16	28
Theatre	-	25	60
Reception	-	-	120



## ROOM OPTIONS IN MORE DETAIL

### THE GALLERY

Perfectly formed traditional suite with views of the south gardens

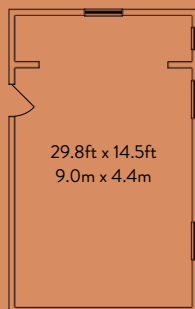

#### BOARDROOM

up to 14 delegates

#### CLASSROOM

up to 12 delegates

#### U-SHAPE

up to 12 delegates

#### THEATRE

up to 10 delegates

#### RECEPTION

up to 30 delegates

#### PRIVATE DINING

up to 14 guests

### THE MOAT ROOM

Well-appointed with oak wall coverings and comfortable seating. The room overlooks the hotel's medieval moat and offers access to a private deck with outdoor seating.

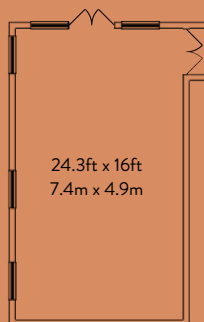

#### BOARDROOM

up to 20 delegates

#### CLASSROOM

up to 16 delegates

#### U-SHAPE

up to 16 delegates

#### THEATRE

up to 25 delegates

#### RECEPTION

up to 25 delegates

#### PRIVATE DINING

up to 20 guests

### MULBERRY

An inspirational setting with windows denoting an entire side of the room for maximum sunlight.

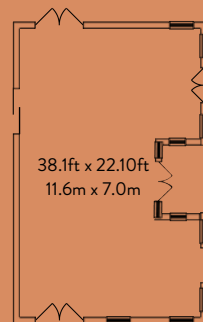

#### BOARDROOM

up to 30 delegates

#### CLASSROOM

up to 20 delegates

#### U-SHAPE

up to 28 delegates

#### THEATRE

up to 60 delegates

#### RECEPTION

120

#### PRIVATE DINING

up to 60 guests



The  
ALEXANDER HOTEL  
Collection



Yoga



Clay shooting

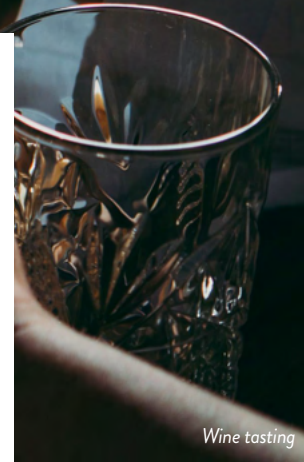

Wine tasting

*Team Building*

Across our five properties, set across beautiful gardens and grounds, we have plenty of great team building solutions. From ice breakers to creative exercises, learning new skills as well as more traditional team building activities, there's something for every team to enjoy.

Contact our events team to discuss your requirements.



Honey tasting experience



Woodland Walks



Archery

# The ALEXANDER HOTEL *Collection*

FOR MORE INFORMATION PLEASE  
CONTACT YOUR CHOSEN PROPERTY

## ALEXANDER HOUSE

Holly Cadogan-Wall • [ahsales@alexanderhotels.com](mailto:ahsales@alexanderhotels.com)

## GREAT FOSTERS

Carla Bowles • [gfsales@alexanderhotels.com](mailto:gfsales@alexanderhotels.com)

## ROWHILL GRANGE

Becky Bell • [rgsales@alexanderhotels.com](mailto:rgsales@alexanderhotels.com)

## BARNETT HILL

Carla Bowles • [bhsales@alexanderhotels.com](mailto:bhsales@alexanderhotels.com)

## LANGSHOTT MANOR

Holly Cadogan-Wall • [lmsales@alexanderhotels.com](mailto:lmsales@alexanderhotels.com)

